

NOTES:

1. SUBSTRATE:
H-K51
2. COATING (APPLY ACROSS CLEAR APERTURE)
S1 & S2: MgF₂ (400-700nm)
R(AVG) ≤ 1.75% @ 400 - 700nm
3. CENTERING: ≤30 ARCMIN

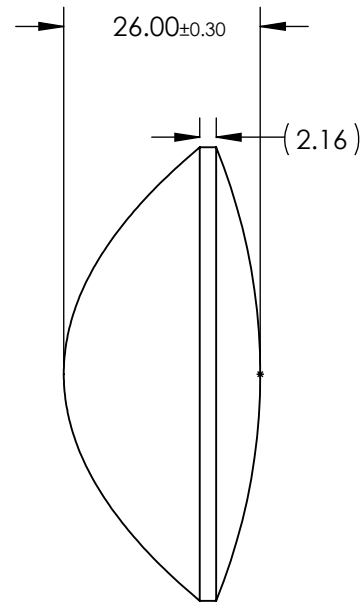
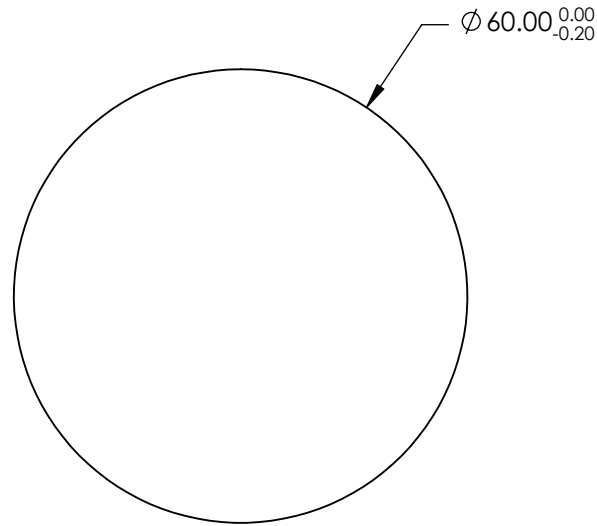

FOR INFORMATION ONLY:
DO NOT MANUFACTURE
PARTS TO THIS DRAWING

SPECIFICATIONS SUBJECT TO CHANGE WITHOUT NOTICE
DIMENSIONS ARE FOR REFERENCE ONLY

| | S1 | S2 |
|-----------------|---------------------|---------------------|
| SHAPE | CONVEX | CONVEX |
| SURFACE QUALITY | 80-50 (typical) | 80-50 (typical) |
| CLEAR APERTURE | Ø 54.00 | Ø 54.00 |
| BEVEL | PROTECTED AS NEEDED | PROTECTED AS NEEDED |

| | |
|------------------------|-------|
| EFL @ 587.6nm | 39.80 |
| BFL @ 587.6nm | 25.58 |
| THIRD ANGLE PROJECTION | |
| ALL DIMS IN | mm |

Edmund Optics®

TITLE 60mm Dia. x 39.8mm FL, MgF₂ Coated, Aspheric Condenser Lens

DWG NO 23816

SHEET 1 OF 1